Event Numbers 2018100914 / 2018100915/ 2018100916
Sat June 9th 9 AM Sat June 9th 1 PM Sun June 10th 9 AM

PREMIUM LIST
ALL BREED & ALL AMERICAN (Mixed Breed)
COURSING ABILITY TESTS



Cudahy Kennel Club, Inc.
(Licensed by American Kennel Club)

American Legion Post 434
9327 S Shepard Avenue, Oak Creek, WI

CAT Field is completely fenced in for dogs' safety
60 dogs per test

Saturday June 9, and Sunday June 10, 2018

Entries **close** Wednesday, June 6, 2018 at 8 p.m.

Entries will be accepted for All American dogs listed in the AKC Canine Partners Program



Permission is granted by the American Kennel Club for the holding of these events under the American Kennel Club rules and regulations. Gina DiNardo, Secretary

Cudahy Kennel Club
Field Secr: Mary Beth Hackney
713 Blake Ave
South Milwaukee, WI 53172

Please Rush - Dated Material
First Class Mail

Entry Fees

Entry Fee **\$25 per dog and must be made by Wednesday, June 6th at 8 p.m. to the Test Secretary's address.**
No "Day of Test" Entries.

Open to all dogs at least 1 year of age by the day of the test that are individually registered with the American Kennel Club, recorded in the FSS program, dogs with PAL numbers, and dogs enrolled in the AKC Canine Partners program.

A dog may enter only once per event. Each event has an individual event number.

Phone, fax, and email entries will NOT be accepted.

Entries close at the Test Secretary's address Wednesday, 8:00 p.m., June 6, 2018.

MAKE ALL CHECKS/MONEY ORDERS PAYABLE TO: Cudahy Kennel Club. Canadian exhibitors must make fees payable in U.S. funds. Exhibitors whose checks are returned for NSF will be assessed a \$25.00 service fee. Entries will not be accepted if received without a signature or fees. An official American Kennel Club Entry Form must be used. Telephone and telegraph entries cannot be accepted. No entry will be accepted which is made subject to conditions.

Trial Secretary
Mary Beth Hackney
713 Blake Avenue
South Milwaukee, WI 53172
ckchackney@yahoo.com
414-762-1796

PLEASE NOTE: If entry is sent via next day air service (UPS), airborne express, Federal Express, express mail, etc. Please indicate that no signature is necessary upon arrival or entry may not be accepted.

Ribbon Prizes

- An Orange Ribbon will be awarded to each dog receiving a qualifying score.
- Special Ribbon for dogs completing their CA/CAA, CAX, and CAX2 title. Mention that your dog earned one as you leave the course.

Directions to Show Site

Interstate 94 to Ryan Road Exit (322), then East on Ryan Road 1.8 miles to Shepard Avenue. Left onto Shepard Av for 0.5 miles on the left.

American Legion Post 434
9327 S Shepard Avenue, Oak Creek, WI

MOTELS

The following motels will accept well-mannered dogs: **Please confirm when making your reservation.**

Red Roof Inn - 6360 S. 13th St, Oak Creek WI 53154
414-764-3500; redroof.com

La Quinta Inn - 7141 S. 13th St, Oak Creek WI 53154
414-762-2266; LQ.com

Motel 6 - 1201 W. College Ave, Oak Creek WI 53154
414-764-1776 motel6.com

Please clean up after your dogs so you will be welcome in the future. Keep in mind that the hotel is an extension of the test grounds. The same rules that apply to the test grounds also apply to the hotel and its grounds.

Field Conditions, Fencing, Facilities and Food

- Mowed grass field, mostly flat.
- The field is fully fenced in for the safety of the dogs.
- Inside and portable restrooms will be available on site.

Am. Legion Post will not be serving food. There are several fast food restaurants within easy driving distance. There will be complimentary food and beverages for all workers.

Judges and Their Assignments:

Brian Moodhart (100278), 19013 2 Mile Rd, Franksville, WI 53126
Tina Moodhart (100277), 19013 2 Mile Rd, Franksville, WI 53126
Denise Scanlan (ZE233), 1517 Virginia Av, Rockford, IL

Day	Event Number	All Breeds
Saturday AM, CAT 1	2018100914	Brian Moodhart
Saturday PM, CAT 2	2018100915	Tina Moodhart
Sunday AM, CAT 3	2018100916	Denise Scanlan

Test Schedule:

Event	Hours	Entry Close	Inspection	Start of
Saturday CAT	8 AM to finish	No Day of Entries	8 AM to end of test	9 a.m.
Saturday CAT 2	12:30 PM to finish	No Day of Entries	12:30 PM to end of test	1 p.m.
Sunday CAT 3	8 AM to finish	No Day of Entries	8 AM to end of test	9 a.m.

Entry Fee: \$25 per dog must be made by Wednesday, June 6th at 8 p.m. at the Test Secretary's address.
No "Day of Test" Entries.

All handlers must have dogs inspected prior to each test.
A handlers meeting will be held at the start of each event

Dogs are assigned a running order after entries are received. If late for your run time, you will be moved to the end of the run order

Any dog not present when the test ends will be considered absent.

AKC Rules, Regulations, Policies and Guidelines are available on the American Kennel Club Web site, www.akc.org

Officers of Cudahy Kennel Club, Inc.

President	Pam Brown
Vice-President	Melanie White
Treasurer	Denise Nelson
Recording Secretary	Fran Aring
Corresponding Secretary	Wendy Anderson

Board of Directors

Don Adams, Dirk Anderson, Dave Bronikowski, Nancy Freitag, Kay Pedersen, Bev Sigl-Felton

FIELD CHAIRMAN

Greg Oberdorf
626 Sherman Av
South Milwaukee, WI 53172
(414) 429-1436
ogrego2001@yahoo.com

FIELD SECRETARY

Mary Beth Hackney
713 Blake Avenue
South Milwaukee, WI 53172
(414) 762-1796
ckchackney@yahoo.com

Lure Operators: Dirk Anderson, Pam Brown, Jan Guthrie, Denise Nelson, Greg Oberdorf, Tim Reed

Event Committee Members: Jan Guthrie, Larry Hackney, Mary Beth Hackney, Denise Nelson, Greg Oberdorf,

Veterinarian on Call

Lakeshore Veterinary Specialists
2400 W. Ryan Road
Oak Creek WI 53154
Ph- 414-761-6333

DIRECTIONS TO EMERGENCY VET:

Shepard Av South 0.5 miles to Ryan Rd. Ryan Rd. west about 2.3 miles to 2400 W Ryan Rd/Lakeshore Veterinary Specialists on the right.
Total is 2.7 miles and 5 minutes. This is a 24-hour facility.

Attention Exhibitors

These tests may be canceled in the event of extreme weather conditions. No refunds and/or fees will be given if the tests cannot be held or completed due to riots, civil disturbances, an act of God, extreme or dangerous weather conditions, public emergency, or any other reason beyond the control of CKC.

Acknowledgment of entries will be made as soon as practical after the closing date with the Judging Program and directions to the test site. Should such acknowledgment not be received by the exhibitor within a reasonable time, please contact the Field (Test) Secretary.

REFUNDS AND FEES: Entry fees shall not be refunded in the event that a dog is absent, disqualified, excused by a Veterinarian or Judge, or barred from competition by action of the Event Committee. Post dated and returned checks do not constitute a valid entry fee. The test-giving Club will add a collection fee to the amount of each returned check (\$20). Subsequent returned checks from the same exhibitor may result in their being put on a cash only basis.

Refunds for **bitches in season** will be refunded, if requests are submitted to the Field (Test) Secretary at least 30 minutes prior to the start of judging for the day and are accompanied by a veterinarian certification if requested by the committee. If in the opinion of the inspection committee, any entry is found to be **lame, unfit to compete or a female in season** and not be allowed to enter, entry fees shall be refunded.

CKC CLUB RULES: No smoking is permitted on the grounds. Exercise your dogs only in posted areas and clean up after them! Exhibitors must exercise control over their dogs & children at all times while on the test grounds. No gasoline or diesel generators are permitted inside of any building or within 100 feet of any tent/building/fence line in which this event is conducted.

CKC assumes no responsibility for any loss, damage or injury sustained by exhibitors, their dogs or property, children or guests.

Neither the event committee nor the trial-giving club will be responsible for the loss or damage to any dog on the trial grounds, whether as a result of an accident or any other cause. It is clearly understood that every dog entered in the trial is in the care, custody and control of its owner or handler during the entire time the dog is on the test premises.

Exhibitors, Owners & Agents assume all responsibility for dogs & equipment on the show site.

Mixed breed dogs that have been listed with AKC Canine Partners may participate provided their listing number has been recorded on the entry form. Breed should be marked as "All American Dog."

ERRORS ON ENTRIES: Owners are responsible for the accuracy of the information required on the entry form. **Changes, additions, or corrections to an entry, entry substitutions, or cancellations by the owner must be received in writing (email accepted) by the Field Secretary prior to the closing date of the trial.** Other means of notification will not be accepted.

JUDGING: Exhibitors are responsible for being ready at the ring gate for judging. The Judging Program will be sent to exhibitors at least 24 hours prior to test. Judging schedule conflicts should be resolved with the field secretary prior to the start of the event. Neither the Field Secretary nor any other individual is obligated to call or notify exhibitors when they are due in the ring for judging. Judges are not required to wait for any exhibitor. Dogs need be present only for inspection and scheduled judging and will be released if not needed for further judging.

CONDUCT: It is expressly understood that all owners/agents/exhibitors are solely responsible for the behavior of their dogs and/or children. Any person(s) whose dog and/or children create unnecessary disturbances or repeatedly engage in unsafe or disruptive behavior may, at the discretion of the Event Committee, be asked to leave the test site. In such cases no refund of any fees/monies paid will be made.

All owners/agents/exhibitors and other persons attending these trials hereby waive any claim against the club or its agents, for any losses, damages, or injuries affecting self, dogs, children, or personal property.

TEST SITE: All dogs must be held on a leash or confined to a crate except when in the ring for judging. Dogs must be on a leash when being exercised, trained or when warming up. Do not crate within 10 feet of the fence line or test equipment. Dogs must be removed from the test grounds immediately following the end of the test.

CKC reserves the right to remove any dog in distress in a parked vehicle or crate.

Please keep the grounds clean by picking up after yourself and your dog. Dispose of 'poop' bags in the trash containers provided there. Please keep your crating area, the trial site, and motel rooms and grounds clean so we may continue to be welcomed at these facilities.

WARM-UPS and training should be conducted in a sportsman-like manner to your dog, other dogs and competitors.

CONCESSIONS Fast food restaurants are located near-by or you may bring your own food. There will be complimentary food and beverages for all workers.

VACCINATIONS: Exhibitors should follow their veterinarians' recommendation to assure their dogs are free of internal and external parasites, any communicable diseases, and have appropriate vaccinations.

What Must A Dog Do To Pass The C.A.T.? The Coursing Ability Test (C.A.T.) is a pass/fail . During a Test the dog runs the course once without any other dogs. Because safety is of the utmost importance, the C.A.T. takes into consideration the individual dog pursuing qualification and therefore has multiple course lengths to accommodate the type and size of the entrant. In either case, dogs will chase a lure made of plastic strips or bags.

Dogs Less Than 12” Tall & “Flat Faced” Dogs. Any entrant that is less than 12” tall at the withers and/or brachycephalic will run a 300-yard course with turns no more acute than 90 degrees. *For a 300-yard course, a dog must complete the test in less than 1 ½ minutes.* If your dog will be running the 300 yard course, please check the appropriate box on the entry form.

Dogs 12” or Taller. Any entrant that is 12” or taller at the withers and not brachycephalic shall run a 600-yard course (or as close to 600 yards as possible) with turns no more acute than 90 degrees. *For a 600-yard course, a dog must complete the test in less than 2 minutes.*

Shorter Distance for Veteran Dogs: Veteran dogs may be allowed to run two-thirds of the normal distance at the handler’s discretion. For the purpose of CAT tests, veteran dogs are defined as dogs 7 years of age or older. The handler must declare prior to the start of the dog’s run which distance the dog will run. This means that a veteran dog which would normally run the 300 yard course may run 200 yards and a veteran dog which would normally run the 600 yard course may run 400 yards. Time to complete the course remains the same. Veteran dogs completing the shorter course will continue to earn legs toward the current CAT titles. The premium for the event shall state the distance for each course, including that veteran dog’s may run two-thirds of the normal course distance at the owner’s discretion. (change to section 9)

If there is a question which course a dog should run, the judge will decide. In order to pass, the dog must complete the course with enthusiasm and without interruption within the maximum amount of time for the course length. The judge keeps the official time and decides the merits of the dog’s performance.

C.A.T. Titles: The appropriate titles (from the four titles below) will be awarded to dogs that pass the Coursing Ability Test the required number of times. These are suffix titles that will appear on a dog’s pedigree with a higher-level title superseding a lower level title.

- **Coursing Ability (CA)** – Awarded to a dog that passes the Coursing Ability Test three times under at least two different judges.
- **Coursing Ability Advanced (CAA)** - Dog passes the Coursing Ability Test ten times.
- **Coursing Ability Excellent (CAX)** – Dog passes the Coursing Ability Test 25 times.
- **Coursing Ability Excellent 2 (CAX2)** – Dog passes the Coursing Ability Test 50 times. A higher numbered title will be awarded for every additional 25 passes.

General:

1. All entries must be one year of age or older on the day of the test or trial.
2. Dogs not present by the end of the test will be scratched.
3. Each entry will be examined at inspection. Inspection shall take place prior to any form of wrapping being applied to the dog. In the opinion of the inspection committee, any entry found to be lame, unfit to compete, or a female in season shall not be allowed to enter and entry fees shall be refunded.
4. Dogs will be inspected before each Event.
5. Run order will be based on order set by the field committee. We will separate the running of multiple dogs handled by a single handler. If a dog is late for their run time they will run at the end of the running order.
6. Dogs may wear any collar except a choker collar, a collar with prongs or an electronic training collar. The collar should be snug to minimize the chances of getting hung up on something during the run. Owners should be aware that there is a chance that tags hanging from the collar could become entangled on something during the run. Owners may use clips or rubber bands to hold the dog’s hair. The owner assumes responsibility for the safety of the dog with regard to the dog’s collar and paraphernalia on the dog.
7. Gas/Electric continuous loop machines will be used. Lure will consist of white plastic bags or plastic strips.
8. The field committee reserves the right to alter the course plan as required by weather and/or field conditions on the day of the trial.
9. The event/field committee reserves the right to bar known aggressive dogs from the event site.
10. The Field Chairman may levy and collect a penalty fee of \$5.00 from the owner or his duly authorized agent of any dog that is loose on the field and not in competition at the time; or for anybody caught not picking up after their dog or leaving garbage on the field.
11. No one will be allowed on the field without the express permission of the field chairman, except the appointed field committee.
12. Anybody exhibiting unsportsmanlike behavior will be excused from the field and may be subject to further disciplinary action.
13. Control of dogs strictly enforced, on leash at all times except when running.
14. Clean up and carry out all trash.
15. Please pick up after your dog and put in receptacles provided at site

Course maps

Course Maps #1 & #2 – Saturday AM & PM (reversed)

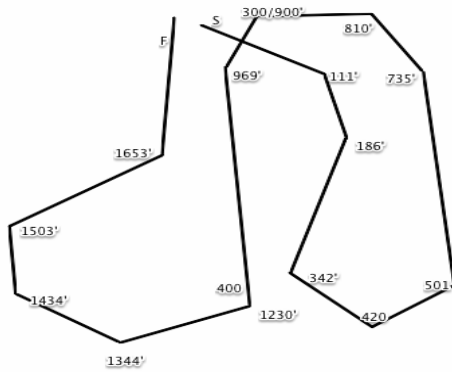

Course Map #3 – Sunday

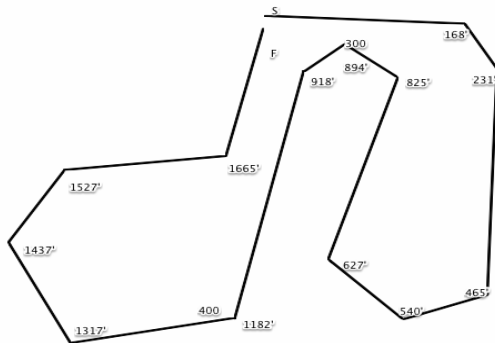

Remember to reserve the following dates for future Cudahy Kennel Club trials:

AGILITY

JUNE 22 - 24, 2018
SEPTEMBER 9, 2018
NOVEMBER 24 & 25, 2018

COURSING ABILITY TESTS (CAT)

MAY 12 & 13, 2018
JUNE 9 & 10, 2018
SEPTEMBER 22 & 23, 2018
OCTOBER 6 & 7, 2018

CONFORMATION

AUGUST 10, 2018

Fast CAT

MAY 26 & 27, 2018
JULY 14 & 15, 2018
OCTOBER 27 & 28, 2018

OBEDIENCE/RALLY

APRIL 14 & 15, 2018
DECEMBER 29 & 30, 2018

Scent Work Trial

MARCH 3 & 4, 2018
NOVEMBER 17 & 18, 2018

Please visit cudahykennelclub.org for premiums and for information on our classes and other events.

CAT Fun Run

Sunday, June 10th after the morning CAT test:

The first run will be shortly after the CAT test ends. But the CAT test crew will take a break for lunch from 12:30 to 1 p.m. and then return to continue the Fun Run. We'll see if the CAT test's end time allows us to start the Fun Run before the lunch break. If all goes well, we could be ready to start the Fun Run about 11:30 a.m.

Fun Run on the course used in the morning for \$5 per run. Any dog can run.

If you would like to pre-register:

Owner's Name: _____

Dog's Call Name: _____

Breed: _____

Owner's email address: _____

Distance _____

The payment can be included with the payment for the CAT test

Worker Signup Form

Volunteers will be gratefully accepted for this trial. There will be food and beverages for all workers. Thanks for helping to continue the spirit of CAT by volunteering & in making the test run smoothly!!!

Name(s) _____

If volunteers are not entered, please list email or phone:

List any special requests:

Email to or send with entry: Mary Beth Hackney at
ckchackney@yahoo.com

Don't forget to ask for your Volunteer Punch Card after you have helped so that you can use it to pay for up to ½ of future test/trial fees.

**CUDAHY KENNEL CLUB
OFFICIAL AMERICAN KENNEL CLUB LURE COURSING
ENTRY FORM**

\$25 per run. Please circle Date and Event number of event signing up for.

* NOT REQUIRED

Location:, VFW Post 434 Oak Creek, WI		Date & Event: (circle)	
Event type: CAT Test		6/9/18 AM Event #2018100914	
		6/9/18 PM Event # 2018100915	
		6/10/18 AM Event # 2018100916	
Breed:		Entry fees enclosed:	
Breeder: *		Sex:	Date of Birth:
Call Name:	AKC No. CP PAL/ILP No.	List Country:	
Full Name of Dog:			
Sire: *			
Dam: *			
Actual Owner(s):			
Owner's Address:			
City:		State:	
Name of Owner's Agent/Handler (if any) at Trial:			
Distance <input type="checkbox"/> 200 yds <input type="checkbox"/> 300 yds <input type="checkbox"/> 400 yds <input type="checkbox"/> 600 yds			
<input type="checkbox"/> Please Separate My Entries..			
AKC Rules, Regulations, Policies and Guidelines are available on the American Kennel Club website: www.akc.org			
AGREEMENT			
I certify that I am the actual owner of the dog, or that I am the duly authorized agent of the actual owner whose name I have entered above. In consideration of the acceptance of this entry, I (we) agree to abide by the rules and regulations of The American Kennel Club in effect at the time of this event, and any additional rules and regulations appearing in the premium list of this event and entry form and any decision made in accord with them. I (we) agree that the club holding this event has the right to refuse this entry for cause which the club shall deem sufficient. In consideration of the acceptance of this entry and of the holding of this event and			

<p>of the opportunity to have the dog judged and to win prizes, ribbons, or trophies, I (we) agree to hold the AKC, the event-giving club, their members, directors, governors, officers, agents, superintendents or event secretary and the owner and/or lessor of the premises and any provider of services that are necessary to hold this event and any employees or volunteers of the aforementioned parties, and any AKC approved judge, judging at this event, harmless from any claim for loss or injury which may be alleged to have been caused directly or indirectly to any person or thing by the act of this dog while in or about the event premises or grounds or near any entrance thereto, and I (we) personally assume all responsibility and liability for any such claim; and I (we) further agree to hold the aforementioned parties harmless from any claim for loss, injury or damage to this dog. Additionally, I (we) hereby assume the sole responsibility for and agree to indemnify, defend and save the aforementioned parties harmless from any and all loss and expense (including legal fees) by reason of the liability imposed by law upon any of the aforementioned parties for damage because of bodily injuries, including death at any time resulting there from, sustained by any person or persons, including myself (ourselves), or on account of damage to property, arising out of or in consequence of my (our) participation in this event, however such, injuries, death or property damage may be caused, and whether or not the same may have been caused or may be alleged to have been caused by the negligence of the aforementioned parties or any of their employees, agents, or any other persons. I (WE) AGREE THAT ANY CAUSE OF ACTION, CONTROVERSY OR CLAIM ARISING OUT OF OR RELATED TO THE ENTRY, EXHIBITION OR ATTENDANCE AT THE EVENT BETWEEN THE AKC AND THE EVENT-GIVING CLUB (UNLESS OTHERWISE STATED IN THIS PREMIUM LIST) AND MYSELF (OURSELVES) OR AS TO THE CONSTRUCTION, INTER- PRETATION AND EFFECT OF THIS AGREEMENT SHALL BE SETTLED BY ARBITRATION PURSUANT TO THE APPLICABLE RULES OF THE AMERICAN ARBITRATION ASSOCIATION. HOWEVER, PRIOR TO ARBI- TRATION ALL APPLICABLE AKC BYLAWS, RULES, REGULATIONS AND PROCEDURES MUST FIRST BE FOLLOWED AS SET FORTH IN THE AKC CHARTER AND BYLAWS, RULES, REGULATIONS, PUBLISHED POLICIES AND GUIDELINES.</p> <p>Signature of owner or agent duly authorized to make this entry:</p> <p>Emergency Contact (optional):</p> <p>Email:</p>
--

ALR999 (02/11) v1.1P-Edit

MEDIA RELEASE FORM

By signing and submitting my entry for this event, I hereby authorize club-appointed videographer and/or photographer to use, reproduce, and/or publish photographs and/or video that may pertain to me, including my image, likeness and/or voice without compensation. I understand that this material may be used in various publications, public affairs releases, recruitment materials, websites, Cudahy Kennel Club Inc, Yahoo group or Facebook page, or for other related endeavors. This authorization is continuous and may only be withdrawn by my specific rescission of this authorization. Consequently, Cudahy Kennel Club Inc may publish materials, use my name, photograph, and/or make reference to me in any manner that the Corporation or project sponsor deems appropriate in order to promote/publicize their event or service opportunities.

Please visit cudahykennelclub.org for information on our classes and other events.